

Seventy-Fourth Season

## Mainstage

### **The Rainmaker**

September 4 - 21, 2008

### **Children of Eden**

October 9 - 26, 2008

### **Bloody Murder**

January 15 - February 1, 2009

### **A Doll's House**

March 19 - April 5, 2009

### **Perfect Wedding**

April 30 - May 17, 2009

### **Man of La Mancha**

June 4 - 28, 2009



# Weathervane

## PLAYHOUSE

John Hedges, Executive Director

## John L. Dietz Theater

### **Love! Valour! Compassion!**

October 30 - November 15, 2008

### **Intimate Apparel**

February 26 - March 14, 2009

## Young Actor Series

### **Go, Dog. Go!** and

### Disney's **The AristoCats Kids!**

July 25 - August 10, 2008

### **Joseph and the Amazing Technicolor Dreamcoat**

November 25 - December 21, 2008

### **A Midsummer Night's Dream**

February 10 - 22, 2009

## Special Presentation

### **Amahl and the Night Visitors**

December 6 - 20, 2008

*Life Is Believing*  
2008-2009 Season

1301 Weathervane Lane • Akron, OH 44313-5186  
[www.weathervaneplayhouse.com](http://www.weathervaneplayhouse.com)



**EXPERIENCE MORE**



At Audio-Technica, we are grateful for, and very proud to support, the local arts near our company's U.S. headquarters in Stow, Ohio. We look forward to many years of inspiring listening. Wherever your passion for music takes you, experience more.

[audio-technica.com](http://audio-technica.com)

 **audio-technica.**  
*always listening*



**One chance. Get it right. Make an impact.**

**Specialized Services, Equipment Rental & Sales for theatre, corporate functions, schools, churches, community gatherings, and concerts.**

We are proud to support The Greater Akron Community and beyond with a polished, professional level of service for live events and the people who support them.

- Wireless microphone systems
- Specialized microphones
- Theatrical and LED lighting fixtures
- Intelligent lighting consoles
- P.A. systems, digital mixing consoles, and monitors
- Video projectors, screens, and dress kits
- Special effects, cables & accessories

**Live event audio recording: packages from 2 to 24 tracks**  
**Video display, recording, editing, and post-production**  
**On-site delivery, setup, and pickup for rental equipment**  
**Technical support on all levels, even after hours**

1653 Merriman Rd. Suite L5 / Akron, Ohio 44313

Office: 330-835-9910 Fax: 330-835-9914

[sales@ClearGoldAudio.com](mailto:sales@ClearGoldAudio.com) [www.ClearGoldAudio.com](http://www.ClearGoldAudio.com)

# Ohio Arts Council

Shaping Ohio's Communities Through the Arts  
Culturally, Educationally and Economically

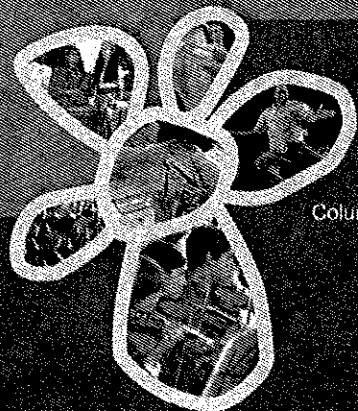

Visit ArtsinOhio.com to search quickly for thousands of performances, events, festivals and exhibitions that are sure to move you.

ArtsinOhio.com is a collaboration of Experience Columbus, the Convention & Visitors Bureau of Greater Cleveland, CincinnatiUSA.com and the Ohio Arts Council.

**ArtsinOhio.com**

The only site you need for arts and cultural events in Ohio

727 East Main Street • Columbus, OH 43205-1796  
614/466-2613 • [www.oac.state.oh.us](http://www.oac.state.oh.us)



Ohio Arts Council

Lots to Do  
Downtown...  
One Great Place  
to Eat!

akron | cleveland

1 west exchange st. akron, ohio 44308 phone 330.475.1600 [www.briccodowntown.com](http://www.briccodowntown.com)  
mon-thu: 11am - midnight fri: 11am - 1am sat: 4pm - 1am closed most sundays

**Don Drumm**  
Studios & Gallery  
437 Crouse St., Akron  
330.253.6268  
m-f: 10-6, sat: 10-5  
500+ artists

introducing new friends/critters...

**shop on-line:**  
**DonDrumm.com**

**akron area arts alliance**  
BUILDING COMMUNITY THROUGH ARTS & CULTURE

[www.akronareaarts.org](http://www.akronareaarts.org)  
event calendars for 46 arts organizations  
educational & volunteer opportunities

[www.summitartspace.org](http://www.summitartspace.org)  
7 gallery exhibitions annually featuring local artists  
free educational art workshops  
directory of local artists

330-376-8480 • [akronareaarts@abcglobal.net](mailto:akronareaarts@abcglobal.net)

*Inspiring the Promise in Every Child*

**inspire**

**EXCELLENCE IN ACADEMICS, ATHLETICS AND THE ARTS**

Toddler - Grade Eight • Located in the Cuyahoga Valley National Park  
[www.oldtrail.org](http://www.oldtrail.org) • 330.666.1118

Always Inspired. Always Affordable.

**Wayside**  
furniture

[www.wayside-furniture.com](http://www.wayside-furniture.com)  
1367 Canton Road • Akron, OH 44312 • Toll Free 877.499.3968  
Open Monday - Friday 10am - 9pm,  
Saturday 10am - 6pm and Sunday 12pm - 6pm

# Free rent.

On the world's best music.

Always at your public library.

Your Akron Summit County Public Libraries have been offering free rent on the best music, movies, books, education and more since 1874. That makes checking us out worth checking into. Visit [www.akronlibrary.org](http://www.akronlibrary.org) or stop in today.



## Weathervane's Staff

**John Hedges**  
Executive Director

**Janis L. Harcar**  
Director of Advancement

**Keith D. Campbell**  
Director of Audience Development

**Melanie Y.C. Pepe**  
Director of Education  
Young Actor Series Producer

**Alan Scott Ferrall**  
Scenic Designer / Technical Director

**Barbara Trotter**  
Coordinator of Volunteers

**Lisa Mansfield**  
Patron Services Manager

**Drea Jean L. Brown**  
Data Services Manager

**Benjamin Rexroad**  
Public Relations and Outreach Assistant

**Jasen Smith**  
Costume Shop Manager / Costume Designer

**Nancy Humes**  
Education Assistant

**Kathryn A. Kohl**  
Assistant Technical Director

**Ian S. Haberman**  
Artistic Advisor

**Caroline Klein**  
Bookkeeper

**S & B Services -- Shannon Brown**  
Cleaning Services

**MINX Design, Cecilia Sveda**  
Graphic Designs

**Brockman, Coats, Gedelian & Co.**  
Auditors



**The 5 Browns**  
Classical music's virtuoso siblings  
**October 22, 2008**

**The Cleveland Orchestra**  
Herbert Blomstedt, conductor  
**November 18, 2008**

**Guarneri String Quartet**  
**January 13, 2009**

**Hilary Hahn, violin**  
Valentina Lisitsa, piano  
**February 24, 2009**

► **Renée Fleming, soprano**  
Hartmut Höll, piano  
**April 7, 2009**

**Arnaldo Cohen, piano**  
The Margaret Baxtresser Annual Piano Concert  
**May 5, 2009**

08 | 09  
season

presented by

**tuesday musical**

EJ Thomas Performing Arts Hall • 7:30 pm  
Tickets 330.972.7570 • [www.tuesdaymusical.org](http://www.tuesdaymusical.org)







## 2008-2009 Board of Trustees

### Officers:

Christopher C. Esker .....President  
Chas Schreckenberger.....First Vice President  
Aaron Berke .....Second Vice President  
Lucy J. Randles.....Secretary

Jim Horvath.....Treasurer  
Jack Steele.....Assistant Treasurer  
Helen Fleming.....Women's Board President

### Trustees:

Christopher Agnew  
Barbara Baskin  
Desiree Bolden  
Chic Carlsson  
Timothy H. Champion

Geoff Coyle III  
Sandra Emerick  
Mary Adams Fazio  
Barry Friedman  
Michael Gaffney

Malia Gelfo  
Jay Hershey  
Lucille Humphrey  
Unhee Kim  
Gregg Manes

Margo Parker  
Bess Raines  
Tom Trotter  
Margaret Dietz Ex-Officio

## 2008-2009 Women's Board

### Officers:

Helen Fleming.....President  
Jill Forster.....First Vice President  
Bunny Lacey.....Second Vice President  
Nancy Schafer.....Corresponding Secretary

Janet Heilmeier.....Recording Secretary  
Susan Baker.....Treasurer  
Susie Stech.....Assistant Treasurer  
Margaret J. Dietz.....Immediate Past President

### Committees:

Art Gallery.....Marci Paolucci  
Boutique.....Mary Wolfman  
Assistants:.....Lois Murray, Patrice Bechtol, Janet Clark  
Boutique Treasurer.....Barbara B. O'Connor  
Cast Suppers.....Wendy Cooley  
Assistant.....Carol Seiberling  
Costumes.....Henrietta Cook  
Assistant.....Helen Vari  
Hospitality.....Lois Simmons  
Assistant.....Bess Raines

Hostesses.....Patrice Bechtol  
Assistant.....Pat Obenour  
House.....Sue Smith  
Membership.....Bunny Lacey  
Newsletter.....Nancy Schafer  
Nominating.....Margaret J. Dietz  
Office.....Leslie Lund  
Special Events/Ways & Means.....Susie Stech

## 2008-2009 Production Board

Chair.....Alan Scott Ferrall  
Auditions.....Sue Smith  
Lighting Department.....Erin Katz Ford  
Sound Department.....Dan Jankura  
Properties Department.....Jerry Mirman, Jr.  
Properties Co-Chair.....Todd Dieringer  
Costume Department.....Jasen Smith

Stage Managers.....Judy Willemssen  
Women's Board Rep.....Helen Fleming/Jill Forster

### Ex-Officio:

Executive Director.....John Hedges  
Producer of Young Actor Productions.....Melanie Y.C. Pepe  
House Managers.....Barbie Trotter  
Trustee Liason.....Jack Steele

# SAFE AND SECURE.

## YOUR ASSETS YOUR FUTURE YOUR PEACE OF MIND

Talk with us.  
Together we'll make a plan.

## CHAMPION & COMPANY, LPA

Timothy Champion David Champion Wayne Rice  
Attorneys & Counselors at Law

Elder Law and Eldercare  
Property, Estate and Wealth Preservation Planning  
Fiduciary Services and Probate Law

3296 West Market Street (across from Summit Mall) 330-865-7722

[www.championcompanylpa.com](http://www.championcompanylpa.com)



## Our Generous Donors

*We gratefully acknowledge the support of the following individuals, corporations and foundations.*

### Super Founders (\$10,000+)

City of Akron Department of Planning & Urban Dev.  
Akron Community Foundation – Shaw Fund  
GAR Foundation  
John A. McAlonan Fund of ACF  
*Amahl* sponsorship  
Ohio Arts Council  
Weathervane Women's Board

### Founder's Circle (\$5,000+)

Mary & Dr. George L. DeMetros Charitable Trust  
Margaret J. Dietz  
John A. McAlonan Fund of Akron Community Foundation  
W. Paul & Thora J. Mills Fdn.  
OMNOVA Solutions Foundation  
The Gertrude F. Orr Trust Advised Fund of Akron Community Foundation  
Sisler McFawn Foundation  
Lloyd L. and Louise K. Smith Memorial Foundation  
Margaret Clark Morgan Fdn.  
Summa Health System Foundation

### Platinum Members (\$1,000+)

\*Francia Albrecht  
\*Susan and Patrick Baker  
Roger G. Berk Trust  
Glenn R. and Alice V. Boggess Memorial Foundation  
Buckingham, Doolittle & Burroughs  
FirstMerit Foundation  
\*Helen Davison Fleming ★  
Goodyear Tire and Rubber Co.  
\*Charlotte and Jim Horvath ★  
The Lehner Family Foundation  
Laura R. & Lucian Q. Moffit Fdn.  
The R.C. and Katherine M. Musson Charitable Foundation  
\*National City Bank  
M.G. O'Neil Foundation  
Charles E. and Mabel M. Ritchie Memorial Foundation

### Gold Members (\$500 - \$999)

\*The Anonymous Trucker

\*Mary Ann and Doug Bell underwrites set for *La Mancha*  
\*Sandra ★ and Scott Emerick  
Janet and Jim Heilmeier  
\*Mrs. Annetta Karam  
\*Shelley and Tom Koutnik  
\*Eileen and Gary Leidich  
\*Leslie and Richard Lund  
\*In honor of Margaret J. Dietz from Hank Dietz, Fred Dietz & Susie Dietz Pardee  
\*Michael Russell  
Summit County Internists & Associates  
\*Mary and Mel Wolfman

### Silver Members \$250 - \$499

\*Akron Tool and Die  
\*Sophie & Steve Albrecht  
\*Barbara Baskin ★  
\*Desiree★ and Bruce Bolden  
\*Brockman, Coats, Gedelian and Co.  
\*Beverly and Curt Brown  
\*Chic Carlson ★  
Frank C. Comunale  
\*Roger Dieringer  
\*Todd Dieringer  
\*Mary Beth and Richard Ellison  
\*Barry Friedman ★  
\*Malia Gelfo ★  
\*GoJo Industries, Inc.  
\*Mary and Roy Hartz  
\*Melissa Owens & John Hedges  
\*Jay R. Hershey ★  
\*Libby and Dr. Jack Jacobs  
\*Bonnie M. Jones  
\*Martha Kaltenbach and Thomas R. Trotter ★  
\*Unhee Kim ★  
\*Dr. Edward L. Koosed  
\*Margaret and John McBride  
\*Patricia S. Obenour  
\*Barbara B. O'Connor  
\*John P. O'Neill  
\*Lucy and Ted Randles★  
\*Judy and Roger Read  
\*Dr. & Mrs. Douglas W. Sanders  
\*Steven Schmidt & Rick Krochka  
Beverly Smith  
\*Susan D. Speers

\*Mr. & Mrs. James R. Vargo  
\*Connie and Bob Velotta  
\*Mona Wolfman  
\*Zuckerman Consulting Group

### Patron Members (\$150 - \$249)

Dr. Miriam F. Agins  
\*Amer Insurance Company  
\*David Ashe  
\*Kathleen Ashcroft  
\*Mary and Roland Bauer  
\*Henry Bishop and Karen Wood  
Lisa and Chuck Ayers  
Sally J. Childs  
Mr. & Mrs. G.F. Coyle III  
\*Alice Ann Davies  
\*Marie and Marc Dusini  
\*Christopher C. Esker ★  
\*Dr. & Mrs. Stephen A. Farkas  
\*Mary and John Fazio ★  
\*FirstMerit Bank/Akron  
\*Flexsys America L.P.  
\*Diana and John Gayer  
\*Janis and Raymond Harcar  
\*Marilyn Heagerty  
Lillian L. Hudimac  
\*Judy and Richard Kotick  
Anne and Bill Lowery  
\*Mogen Real Estate Co.  
\*Virginia Moline  
Sheila Motter  
The Moushey Family  
\*Jo Ann Oelschlager  
Cynthia Ross and Jessica Posey  
\*John M. Ream  
\*Helene and Bill Rogovy  
Kim and Chas Schreckenberger★  
\*Sue and Richard Smith  
\*Thomas M. Stephan  
\*Helen Vari  
\*Leo Weill  
\*Harold F. White  
\*Libby and Jeff Wilson  
\*Richard Worswick and John Grafton

### Sustaining Members

(\$100 - \$149)  
Carol and Ken Button



## Our Generous Donors - continued

### Sustaining Members Cont.

\*Brad Custer  
\*Rebecca DeBolt  
Claire and Jim D'Ianni  
Cathy and Lloyd Doering  
\*Bridgit & Steven Dolin  
\*Jon A. Fiume  
Jeane Galehouse  
Shirley and Al Gates  
\*Ellen F. and Karl S. Hay  
\*Mary Ann and Dr. Thomas Jackson  
Dr. Lawrence B. Kaye, DDS  
\*Mary Beth Kluge  
Bruce G. Kriete  
\*Carol Krueger  
\*Ingrid and Frank Kunstel  
Pamela Langston-Cox  
\*Gregg Manes ★  
\*Margaret McDowell Lloyd  
Patti Margolis  
\*The Maynard Family Foundation  
\*Martha S. Mazak  
\*Jo McGarvey  
Vieven and Danny Moore  
\*Nan and Dr. George Nankervis  
\*Marta & Ian Oppenheim  
\*Bessie M. Raines★  
\*Gloria Reich  
\*Nancy and Harold Rex  
Wendy and David Ruggies  
\*Lois and Paul Simmons  
\*Jean and Ethel Soudry  
\*Jack T. Steele★  
Sarah and Ed Steinmark  
\*Paula and John Troche  
\*Linda Waite

\*Edith & Norbert Weisend  
\*Betty J. and Ken Zeigler  
\*June and Dan Zeno  
\*Laurie Zuckerman and Steve Johnson

### Contributing Members

(Gifts of \$75 - \$99)

\*Aaron S. Berke ★  
\*Carol Boyd  
\*Timothy H. Champion ★  
\*Janet & Donne Clark  
\*Mr. & Mrs. John DeYoung  
\*Hope E. Everhart  
\*Linda Heath  
\*Jennifer P. Hodges  
\*Shirley E. Jordan  
Judy and Denny Miller  
\*Margo Parker ★  
Jean Questel  
\*Barbara and Jim Shriner  
\*Barbara and Russell Stevic  
\*James Switzer and Gretchen Laatsch  
\*Linda Wertz and Robert Cunningham

### Other

\*Meena and Puru Agrawal  
Akron Tile and Fireplace Co., Inc.  
\*Eleanor and Richard Aron  
\*Robert Baab  
\*Mary B. Blazewicz  
\*Loretta E. Bower  
\*Jeff Brinton  
\*Dawn B. Carson  
County of Summit Board of Mental Retardation

\*Patricia and Thomas Doak  
\*Gwynn R. Ennis  
\*George J. Gauthier  
Jean Gent  
Maryanna P. Hamburg  
\*Bart P. Hamilton  
\*David W. Kellogg  
\*Phyllis Lerch  
\*Caryn Lintner  
\*Arlene McKinnon  
\*Scott E. Robishaw  
\*Dr. & Mrs. John B. Saks  
Mr. & Mrs. Joseph Saghy  
Sue and Joe Schaut  
\*Raymone Scott  
Pearl D. Sentelik  
Beverly Spaeth  
Sheila and Larry Wallerstein  
Anna M. Zender

### 100-Hour Memberships

\*Jean Blair  
\*Robyn Cooper  
\*Maryanne Cotter  
\*Erin Katz Ford  
\*Kevin Ford  
\*Holly Humes  
\*Dede Klein  
\*Marcia & Tom Marshall  
\*Talley-Nitzel Family

### Matching Gifts

Allstate Giving Campaign  
AT&T  
FirstEnergy  
The Lubrizol Foundation

*\*Denotes renewed individual membership for 2008-2009*

*★ Denotes Trustees*

*Thank you to all our donors!*

*"Giving to others is a key element in well-being. It's abundantly clear from a number of studies that people who live generous lives also live happier lives."*

Dr. Stephen Post  
*Why Good Things Happen to Good People*



## From Our Executive Director

### A Word of Thanks

I'd like to begin by expressing my sincere appreciation to you, our patrons, for your continued support of Weather vane Playhouse. I want to thank you at this point in our season in particular because I am empathetic to your situation. You're sitting here (in the aftermath of the holidays) in our still old and uncomfortable theater seats after having intrepidly made your way through the winter weather of Northeast Ohio (not to mention the treacherous rubble of our demolished -- and temporarily diminished -- lobby) only to spend your money on something completely unknown and unproven -- a brand new play. Bravo and three cheers to you for your courage! Your vision and hope sustain us.



### Lots to Look Forward To

The good news is there is a lot to look forward to. You have a terrific new play, *Bloody Murder*, about to unfold before you that is in the hands of a first-class director and a marvelous cast that I know you're going to enjoy. In addition, the next time you're here to see our stunning new version of *A Doll's House*, much of the new lobby will be finished and you'll begin to really enjoy the amenities that we are working hard to bring you. Your anticipation of new theater seats, however, will have to keep building until late next summer but, in the meantime, you can start composing your favorite story about how the Playhouse used to be in the old days.

### A Lasting Legacy

Speaking of theater seats, I'd be remiss if I didn't mention the last phase of our fundraising efforts for the new building -- our Seat-Naming Campaign! The pitch here is that, for a tax-deductible contribution of \$250 to our building fund, we will attach a specially engraved plate with your name on it to one of our new theater seats. This is a great way to show your support for the Playhouse and, at the same time, have a lasting legacy of your generosity live on at Weather vane for years to come.

Many thanks once again for all you do and I look forward to sharing the energy of live theater with you throughout this exciting new year of change and growth.

Sincerely,

John Hedges  
Executive Director



Weather vane  
— PLAYHOUSE —

74th Season -- 2008-2009 -- Production #536  
January 15 - February 1, 2009

# Bloody Murder

Comedy by Ed Sala

Directed by **NANCY CATES** (SSDC)

Stage Manager  
**JERRY MIRMAN, JR.**

Costume Designer  
**JASEN J. SMITH**

Lighting Designer  
**BOB SCHAEFER**

Properties Designer  
**JUDY WILLEMSSEN**

Scenic Designer  
**ALAN SCOTT FERRALL**

Sound Co-Designers  
**STEPHEN MOUSHEY and EILEEN MOUSHEY**

Weather vane productions are sponsored in part by **Ohio Arts Council**

Weather vane Community Playhouse, 1301 Weather vane Lane, Akron, OH 44313-5186  
Ticket Office: 330-836-2626 • Fax: 330-873-2150 • [weather vaneplayhouse.com](http://weather vaneplayhouse.com)



## About the Play and Playwright

### About the Play

In the spirit of the best Agatha Christie-type "whodunit," several murder-mystery types assemble for a weekend in the English countryside at the lavish estate of Lady Somerset, a woman of great wealth and social standing. Into her Ladyship's parlor comes a colorful collection of characters. We meet the middle-aged maid and head of staff for Lady Somerset's estate; a far-too-innocent ingenue; an enigmatic and well-preserved countess; a self-glorifying Major, who brags of his former military service in India; Lady Somerset's ne'er-do-well nephew; and an actor of former acclaim who at present prefers to drown himself with single-malt Scotch whiskey. When one of the houseguests is suddenly murdered, her Ladyship refuses to let anyone call the police. Instead, she insists that she and her guests are merely characters in a mystery story written by a perfectly dreadful author – and she won't allow the charade to go on any longer! Once a bumbling, dim-witted Chief Inspector of Police arrives on the scene, *Bloody Murder* serves up an hilarious battle of wills between the writer and his creations – and delivers an ending guaranteed to surprise!

Weathervane Playhouse's production of *Bloody Murder* marks the world-premiere staging of Ed Sala's comic murder mystery. Prior to its journey to the Weathervane stage, Sala's script won awards from the Theatre Resources Unlimited Playwriting Festival in New York City and the Appalachian Playwriting Festival at the Barter Theatre in Abingdon, Virginia.

### About the Playwright

Ed Sala holds a Master of Fine Arts degree in playwriting from Virginia Commonwealth University in Richmond, Virginia – but has made his living primarily as an actor. He has performed on Broadway in *The Scarlet Pimpernel*, on the stages of regional theater, on television, in movies and has also narrated several audio books. He played the role of Al on CBS-TV's *Guiding Light*, Captain Bogie Queeg on the PBS-TV show *Square One Television* and had a recurring role on the NBC-TV series *Matlock*. He has played a variety of roles at the Barter Theatre in Abingdon, Virginia, where he also wrote and premiered his original musical comedy, *Alice...Through the Picture Tube*. During his acting career, he has worked with *Bloody Murder* director Nancy Cates and her husband, Terry Burlger – and he has also shared the Barter Theatre stage with Weathervane Executive Director John Hedges. Sala says he prefers writing to acting but reports that when he begins to write a play, he knows what the plot should be, but his characters wrest the action from him. This interaction between the playwright and his creations guided Sala to depict the hilarious battle of wills between *Bloody Murder*'s Lady Somerset and himself. In his preface to the script, Sala writes, "I hope *Bloody Murder* entertains, but also reveals, in a rather unusual way, something of the struggles involved in the creative process." Sala lives in New York City with wife, Renee, and daughter, Emma, who at 13 is already becoming an actress in a program titled *Meet Me at the Corner* (in which she leads tours of local landmarks).



## Bloody Murder -- Cast

Lady Somerset.....	Linda Ryan
Jane.....	Karen L. Wood
Emma Reese.....	Tess Burgler
The Countess.....	Dede Klein
The Major.....	Henry C. Bishop
Devon Tremaine .....	Tom Stephan
Charles .....	Scott Shriner
Chief Inspector Phelps.....	Ron Cuirle

*There will be one 15-minute intermission.*

### Track Your Favorites

Keep track of your favorites all season long and you'll be prepared to vote for our Chanticleer Awards at the end of the season. Use this list as a guide...

Sound Design  
Lighting Design  
Properties Design  
Costume Design  
Lead Actor -- play & musical  
Featured Actor -- play & musical

Supporting Actor -- play & musical  
Lead Actress -- play & musical  
Featured Actress -- play & musical  
Supporting Actress -- play & musical  
Best Production

### For Your Safety...

- ♦ We request that you remain seated until the house lights have come up at intermission and after the curtain call.
- ♦ The use of cameras, recording equipment and laser pointers is forbidden during this performance.
- ♦ As a courtesy to fellow audience members, please make sure that cell phones and pagers are turned off during the performance.
- ♦ Please do not bring food or drink into the auditorium.
- ♦ NOTE: In case of an emergency in which the performance cannot continue, Calamity Vouchers will be issued for a future performance. Thank you.





## About Our Director

Nancy Cates has so enjoyed each of her Weathervane shows: *Blithe Spirit*, *A Man for All Seasons*, *The Two Gentlemen of Verona*, *Communicating Doors*, *Gypsy*, *Lend Me A Tenor*, *All My Sons* and *Moon Over Buffalo*. Having been fortunate enough to be given the opportunity to direct in such a wide variety of genres, she is now delighted to add tonight's show, an original work, to the list. In a twist (almost) worthy of *Bloody Murder*, playwright Ed Sala was performing on stage in an original musical, book co-written by Nancy's husband Terry Burgler, the night their daughter, Tess, playing the role of Emma tonight, was born. Theatre is a small world, and Nancy is grateful to both work upon a clever new script and to encounter Ed again after more than two decades. Nancy and Terry are the founding Artistic Directors of Ohio Shakespeare Festival and the Artistic Directors of Coach House Theatre, both venues being enthusiastic supporters of Weathervane. Nancy is a member of the Society of Stage Directors and Choreographers. (SSDC)

## A Brief History of Weathervane Playhouse

Weathervane Community Playhouse began its run as a live theater in 1935. Four artistically talented Woman's City Club members -- Grace Hower Crawford, Muriel MacLachlan, Laurine Schwan, Helen Troesch -- and a core of charter members rented the empty carriage house belonging to Akron's Senator Charles Dick. Their goal was to present a wide spectrum of plays: classics, dramas, comedies, new works -- even opera -- with casting open to anyone who fit a part.

The "barn" was home until it was sold. In 1951 the Playhouse purchased a cement block building at 1471 Copley Road and renovated it for a theater with seating capacity of 125. During the Copley Road days, plays were presented six days a week. Because of their popularity, not everyone who wanted to see a show could be accommodated. During the 1960s the membership planned, plotted and raised funds. It all came together in June 1970 with the opening of *Dark of the Moon* at this location in the Valley. Weathervane Playhouse now looks forward to a third expansion on the current facility and a 75th anniversary.

### Recent Contributions were made:

In honor of John Grafton and Richard Worswick  
by Vieven and Danny Moore

In memory of Melba Ferrall  
by Margaret J. Dietz, Sheila Motter, Janis Harcar

In memory of Betty Borom  
by Drea Jean L. Brown

In memory of Ginny H. Hershey  
by Patricia McKay and Rev. Duane Angle

In memory of Keith Cantine  
by Steven Cress

In memory of Mary Morehart  
by William E. Buffe



## Biographies

**LINDA RYAN** (Lady Somerset) Linda's theater background began in 1964 in Australia, where she also worked as a radio announcer. Since arriving in America in 1981, she has worked steadily in local theaters including Weathervane, Coach House, Actors' Summit and the Players Guild of Canton. Several part-time acting jobs, including commercials and murder mysteries, keep Linda busy. A retired legal secretary, Linda plays bridge, writes short stories and haiku, plays percussion in a band, volunteers with Mobile Meals, reads, knits, and crochets. An avid games player, when not onstage, Linda loves to spend an evening with her husband, family and friends playing games.

**KAREN L. WOOD** (Jane) recently appeared as 'Stella' in the Coach House production of *Light Up the Sky*. *Bloody Murder* marks Karen's fifth Akron production since her June 1 retirement from North Central Local Schools. In her 25-year history with Weathervane, favorite roles include 'Amalia' in *She Loves Me*, 'Fraulein Schneider' in *Cabaret*, 'Abby' in *Arsenic and Old Lace* and 'Mazeppa' in *Gypsy*. Karen is proud to have been the recipient of six Chanticleer awards. Karen and husband Henry C. Bishop reside in Creston, where they love to sit by the fire and fend off their pet cats!

**TESS BURGLER** (Emma Reese) will graduate this spring from the College of Wooster with a BA degree in Theatre and Dance. Last year, she studied abroad in London and prepared for her senior thesis, an in-depth study of Shakespeare's original practices. Tess last performed on the Weathervane stage in 2007 as Ann Deever in *All My Sons*. Most recently, Tess performed with Coach House Theatre as Shelby in *Steel Magnolias* and at Canton Players Guild as Luciana in *Comedy of Errors*. Other favorite roles include: Diedre in *I Hate Hamlet* (Ohio Shakespeare Festival) and Shy in *Best Little Whorehouse in Texas* (OSF). Love to family and friends—thanks for your unfailing support because it means the world to me!

**DEDE KLEIN** (The Countess, Motorist, Nun) was last seen on our stage as Charlotte Hay in *Moon Over Buffalo*. Prior to that, she appeared as Eleanor in *Lion in Winter*, for which she won the Chanticleer for Best Actress. Dede has also worked at the Ohio Shakespeare

Festival, Coach House, Beck Center, The Bang and the Clatter, Chagrin Valley and Aurora Theaters. Some favorite credits include Elvira in *Blithe Spirit*, Hannah Pitt in *Angels in America*, Amanda in *The Glass Menagerie*, Woman B in *Three Tall Women* and Birdie in *The Little Foxes*. Dede recently retired from American Airlines after 31 years of service. She is pleased to be working with Nancy Cates again along with this fun and talented cast. Figurez Vous!

**HENRY C. BISHOP** (The Major) lives in Wayne County with his wife Karen L. Wood.

**TOM STEPHAN** (Devon Tremaine) is happy to return to Weathervane after appearing in the Dietz black box theater production, *And the Winner Is*, this past spring. Tom was last seen on the mainstage in *Lend Me a Tenor*, also directed by Nancy Cates. Since then he has appeared with the Ohio Shakespeare Festival, the Largely Literary Theater Company and Stow Players. A five-time Chanticleer Award winner, Tom is a retired English and drama teacher from Stow-Munroe Falls High School, and is the longest "surviving" member of *Mysteries by Moushey*. He has served on the boards of Weathervane, Stow Players and a number of community and civic groups. He balances diverse community involvement with voice-over, commercial and industrial video work.

**SCOTT SHRINER** (Charles Pomeroy) last appeared in the Dietz Theatre in *Love! Valour! Compassion!* He has won Chanticleer awards for Weathervane's recent mainstage productions of *Lend Me a Tenor*, *Three Days of Rain*, *Moon Over Buffalo* and *All My Sons*. His favorite role here is Nick Cristano in *Over the River and Through the Woods* in 2005. He has performed with Ohio Shakespeare Festival, The Bang and the Clatter, Coach House and Actors' Summit.

**RON CUIRLE** (Inspector Phelps, Mr. Woo, El Gato, Priest) always has fun working with his friends. He constantly wonders what life would be like without the arts ... then thanks God no one has to experience that. Ron resides minutes away at the top of the hill in Akron with his beautiful, fabulous, fantastic and ever loving girlfriend Emily -- his own personal piece of art.



## Biographies - continued

**JERRY A. MIRMAN, JR.** (Stage Manager) has served Weathervane for the past 21 years as an actor, stage manager and designer of lighting and properties. He is co-chair of the Properties department on our Production Board. Last season, he stage managed our production of *Moon Over Buffalo*, also directed by Nancy Cates. Jerry also stage manages for Ohio Shakespeare Festival at Stan Hywet Hall and Gardens.

**STEPHEN MOUSHEY** (Sound Co-Designer) This is his fifth sound design at Weathervane Playhouse. Previously, he designed sound for *Of Mice and Men*, *Seven Guitars* and (with generous help from Eileen Moushey) *Lend Me a Tenor*, which earned a Chanticleer Award for Best Sound Design. Eileen and Stephen co-designed sound for *And the Winner Is* at Weathervane's Dietz Theatre and are collaborating again for *Bloody Murder*. In addition to working on sound crews for several Weathervane productions, he also continues to work behind the scenes for Eileen and *Mysteries by Moushey*.

**EILEEN MOUSHEY** (Sound Co-Designer) is collaborating once again with husband, Stephen, to design sound for a Weathervane production. She was hooked with *Lend Me a Tenor* and has reluctantly set aside her "opera files" to explore the world of 1920s and 1930s music and mystery sound effects.

**JASEN J. SMITH** (Costume Designer) serves on Weathervane's professional staff as the Resident Costume Designer/Costume Shop Manager. He served for four years as the Costume Designer and Theatre Rentals Manager for Akron Design and Costume. From 2001 to 2004, the College of Wooster employed him as the Costume Designer/Costume Shop Manager. At Wooster, he also served as the resident costume designer for the Ohio Light Opera's 2003 and 2004 summer seasons. Mr. Smith is a 1999 graduate of Huntington College in Montgomery, Ala. In 1997, he worked as a wardrobe assistant for the Alabama Shakespeare Festival, and he designed costumes for its Graduate Acting

Company's production of *The White Devil* in 2001. A resident of Akron, he is a part-time instructor at Case Western Reserve University, where he teaches costume design and construction.

**BOB SCHAEFER** (Lighting Designer) is thrilled to be making his Weathervane debut. His previous work has been primarily at Coach House Theatre where he designed sets for *Steel Magnolias*, *Driving Miss Daisy* (for which he also designed lights), *Art*, *Proof*, *Hay Fever* and *Picasso at the Lapin Agile* -- the latter two for which he won Royal Coach Awards for Best Scenic Design. He sends his love out to his wife Kendra.

**JUDY WILLEMSSEN** (Properties Designer) recently served as Assistant Stage Manager for *Amahl and the Night Visitors* and created the sound design for *Love! Valour! Compassion!* She heads the Playhouse's Stage Management department on the Production Board. A Weathervane volunteer for more than 20 years, Judy has won Chanticleer Awards for sound designs for *Translations*, *The Piano Lesson*, *My Three Angels* and *The Full Monty*. As Stage Manager, she won Chanticleers for *Harvey* and *The Laramie Project*. Judy is the mother of two daughters, Amber and Morgan.

**ALAN SCOTT FERRALL** (Scenic Designer) began his association with Weathervane as a backstage volunteer under the tutelage of the late John R. Thomas. This is Scott's 12th season as a Weathervane staff member. Previously, he worked at Cuyahoga Falls High School. He has designed sets for many local high schools as well as for the Players Guild, Cleveland Signstage Theatre and PBS-TV Channels 45/49. At WCP, Scott has earned five Chanticleer Awards -- one as Stage Manager for *Fences*, and the others for his lighting designs for *The Laramie Project* and *A Lesson before Dying* and co-lighting design for *A Man for All Seasons* and *The Full Monty*. Scott takes great pleasure in writing the end-of-the-season revue for the Not-Ready-for-Mainstage Players, who appear at the annual Chanticleer Awards.



## Production Team

Alan Scott Ferrall -- Technical Director  
Kathy Kohl -- Assistant Technical Director

### SET CONSTRUCTION

Ruth Richardson  
Tom Marshall  
Sandy Horvath  
Len Cheslock  
Todd Dieringer  
Erin Katz Ford  
Kevin Ford  
Bob Schaefer  
David Ruggles  
Clyde Shaw  
Dan Levan  
Barry Levan

### COSTUMES

Suzanne Abernathy  
John S. Catlos  
Randie O. Sass  
Leah Sass  
Judy Snyder  
Paulette Lark  
Scott Davis  
Karen Burridge  
Susie Stech  
Judy Willemssen

### LIGHTS

Erin Katz Ford  
David Ruggles  
Susan Stout-Davis  
Leah Magnus  
Rick Murphy

### PROPERTIES

J.J. McAdams  
Jerry Dorton  
Jen Draher  
Rick Murphey

### SOUND

Mary Kate Clancy  
Lois Bennett  
Cheryl Stadler

### Thanks to Our Hard-Working Volunteers

*The following are the dedicated volunteers who have assisted us recently.*

Linda Algie  
Susan Baker  
Patrice Bechtol  
Mary Blazewicz  
Connie Bowen  
June Bretzin  
Shannon Brown  
Ken Carder  
Gail & Leonard Cheslock  
Wendy Cooley  
Thelma Coss  
M.J. Coulson  
Margaret Dietz  
Nikki Dye  
Helen Fleming  
Erin Katz Ford  
Jill Forster  
Janis Gallagher  
Caroline Garritano  
Steve Garritano  
G.G. Glenn  
Sandra Harding  
Chuck Hass  
Marilyn Heagerty  
Linda Heath  
Dave Hinebaugh  
Fran Howell  
Chuck Kelades  
Evie Kidder  
Carol Krueger  
Leslie & Richard Lund  
Nancy Mahoney  
Miltz Mild

Marlene Miller  
Lois Murray  
Pat Obenour  
Barbara O'Connor  
John O'Neill  
Marci Paolucci  
Lee Peterson  
Jean Questel  
Bess Raines  
Ruth Richardson  
Randie O. Sass  
Carol Seiberling  
Pearl Sentelik  
Nancy Schafer  
Dorothy Shaffer  
Lois Simmons  
Jasen J. Smith  
Sue Smith  
Trish Sorkel  
Pat Spayne  
Jacqui Sukie  
Barbie Trotter  
Verna VanderKovi  
Helen Vari  
Connie Velotta  
Paula Walker  
Michelle Williams  
Marta Williger  
Mary Wolfman  
Gen Woods  
Elizabeth Young  
B.J. Zeigler

### ACKNOWLEDGEMENTS

Fireplace ~ designed and built by Ralph Cooley  
Cutting Room Fabrics  
Nancy Cates  
Linda & Bud Graske

The Longer I Live  
the More Beautiful  
Life Becomes.

— Frank Lloyd Wright



Rockynol...You'll Be Happy to Call Us Home!

ROCKYNOL

Akron's Premier Retirement Community

330-867-2150



Want to get involved?  
Call Barbie Trotter, Coordinator of Volunteers  
330-836-2626 ext. 29



Introducing...

## Weathervane's "Thank You Dollar" Program

This may bring to mind the old joke of an actor asking for a tip and getting the reply "Don't go into Show Business." But this is no joke...

If you like what you've seen at this performance, we ask that you please consider giving a "Thank You Dollar" as you exit the theater. (You'll see a contribution box near the lobby's exit doors.)

As you probably know, earned income accounts for only 60% of our total expenses. The plain fact is, if each Weathervane patron gave just \$1 extra this season, we would be able to meet our goal for Individual Contributions! Won't you show your appreciation of this performance with a "Thank You Dollar" after the show?

**Guide: Thank You \$1**

5% of a \$20 ticket

**Applause! \$2**

10% of a \$20 ticket

**Cheer!! \$3**

15% of a \$20 ticket

**Bravo!!! \$4**

20% of a \$20 ticket

On behalf of all of us here at Weathervane, I thank you for your support.

Sincerely,

John Hedges  
Executive Director

Supporting Artists  
Locally and Globally

Offering fair trade products  
handmade by artisans  
all around the world.

Mon—Thurs: 11-8

Fri—Sat: 11-9

Sun: 1-5



The  
**Market Path**

350 W Market St • themarketpath.com • 330-258-9008

a ministry of:



**First Grace**  
then Faith and Works

Home to the new:

**First Grace Childcare Center**

Opening Fall 2008 • Infants - Preschool

350 S Portage Path • www.firstgraceucc.org • 330-762-5839

*Home: For the Arts in 2009*

**Jacob Marley's Christmas Carol**

December 5 - 20  
and Christmas Eve Dec. 24 at 10 p.m.

**Bach's Spring**

A Birthday Concert of Bach's music at its most lively.  
March 20, 2009 at 8 p.m.

*Bach at Leipzig*  
May 1 - 15, 2009

**1776 In Concert**

July 3 & 4, 2009 at 7 p.m. (note special time)

**NEW MUSICAL WORKSHOP**

August 2009

**stompin' out the footlights**

Rock music from some of Broadway's most exciting shows!  
October 2 - 11, 2009

First Grace United Church of Christ  
350 S. Portage Path  
www.firstgraceucc.org



**Akron Woman's City Club  
COACH HOUSE THEATRE**  
2008/09 Season  
Eighty One Years of Live Theatre

## STEEL MAGNOLIAS

by Robert Harling  
October 2-19, 2008

Directed by Nancy Cates

## LIGHT UP THE SKY

by Moss Hart

December 4-21, 2008

Directed by Terry Burgler

## Appointment with Death

by Agatha Christie  
February 12-March 1, 2009  
Directed by Jim Fippin

## Tonight At 8:30:

"The Red Peppers" & "Shadow Play"  
(2 musical plays by Noel Coward)

April 2-19, 2009

Directed by Nancy Cates

## Not Now, Darling

by Ray Cooney & John Chapman  
May 21-June 7, 2009

Directed by Terry Burgler

**Box Office: 330.434.7741**

Elegant Dining before each Show at The AWCC  
732 W. Exchange St. Reservations: 330.762.6261  
[www.coachhousetheatre.org](http://www.coachhousetheatre.org)

## MAGICAL THEATRE COMPANY

Professional Theatre for Young Audiences & Families  
Producing Directors Holly Burkdoll & Dennis O'Connell

2008-2009

### In Residence

#### Holes

Oct. 10 - 24, 2008

#### The Best Christmas Pageant Ever

Dec. 5 - 21, 2008

#### The Secret Life of Girls

Jan. 27 - Feb. 1, 2009

#### Miss Nelson Is Missing

May 6 - 22, 2009

### On Tour

Call for availability

#### The Princess & the Pea

#### Lincoln: A Man for the Ages

### KidScripts

[www.magicaltheatre.org](http://www.magicaltheatre.org)

**330/848-3708**

565 West Tuscarawas Ave • Downtown Barberton

weekend  
undergraduate and graduate degree programs  
Hiram College



You'll know it when you've found  
the college where you belong.

### Weekend College.

Students earn their bachelor's degrees by taking classes  
every other weekend. 330.569.5162.

Master of Arts in interdisciplinary studies.  
Students earn their master's degrees in as few as two years  
by attending classes every other Saturday. 330.569.6111.



[www.hiram.edu/future](http://www.hiram.edu/future)



## Akron Tile & Fireplace, Inc.

The Shop in the Valley

1812 Meritman Road • Phone 300-867-4087

Gifts & Accessories

Fireplace Fixtures & Accessories

Gas Grills & Gas Logs



Accomini's  
SINCE 1932

Dinner before or after the show  
Minutes from the Playhouse

Fresh Fish ★ Handcut steaks  
Pasta with homemade sauces

1561 Akron-Peninsula Road  
330-923-7999

Open 7 nights a week ★ Sunday 4:00

When it comes to peace of mind,  
expert travel planning  
and member savings,  
AAA is a hard act to follow.

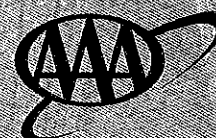

Set the stage for  
great member discounts!



Shop for Savings online at [www.aaa.com](http://www.aaa.com)  
or at one of our four Summit County Locations

Fairlawn Town Center  
2709 W. Market St.  
330-867-0694

Akron-Downtown  
111 W. Center St.  
330-762-0631

Cuyahoga Falls  
1945 23rd St.  
330-923-4826

Hudson Plaza  
178 W. Streetsboro Rd.  
330-650-6727



## Luigi's

"An Akron Tradition  
Since 1949"

- Award Winning Food
- Casual Dining
- Old World Elegance

Featuring Our Famous  
Homemade

- Pizza
- Lasagna
- Antipasto

**OPEN 7 DAYS**  
105 N. MAIN ST.  
**330-253-2999**



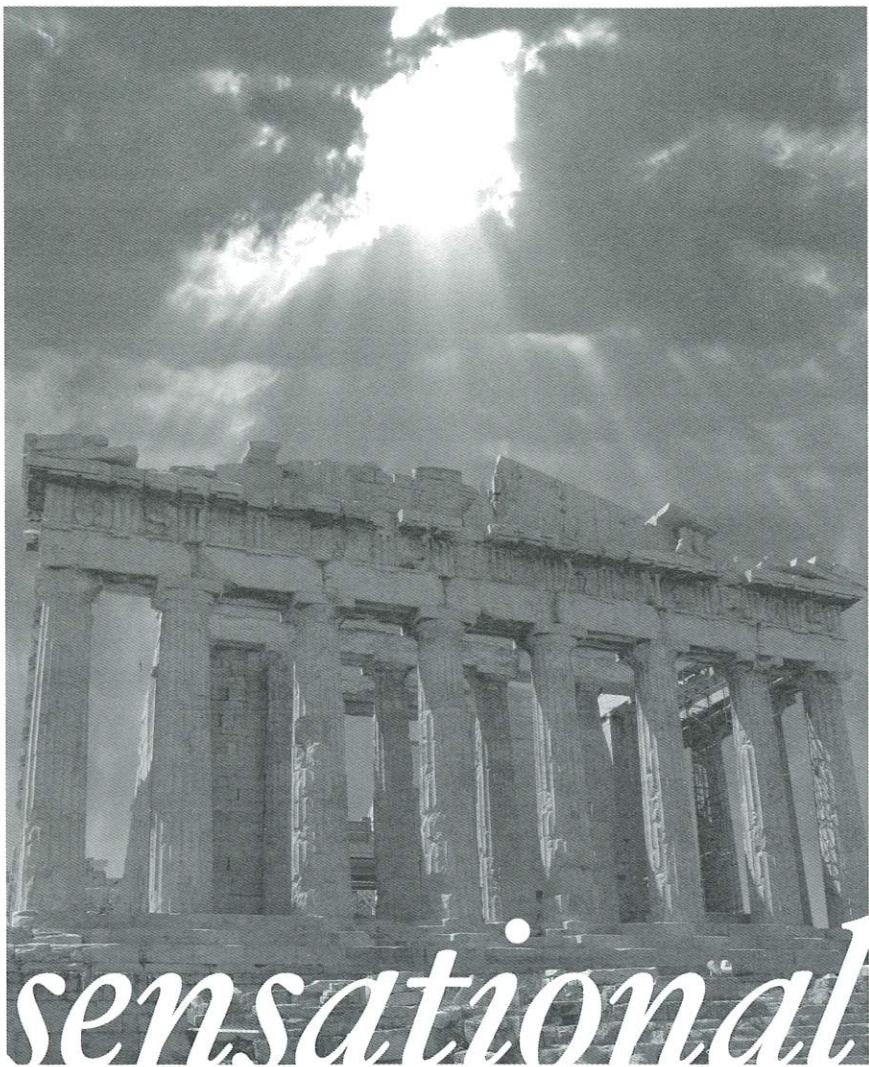

Just because it's not new  
doesn't mean it's not *cool*.



See things  
in a new light.



Turning heads with bright ideas.

**MINX**DESIGN

330.762.4126 • 1.888.GET.MINX

Dramatic Solutions for Print Communication



*Weathervane Playhouse is Setting the Stage for the Future*

Coming in 2009...

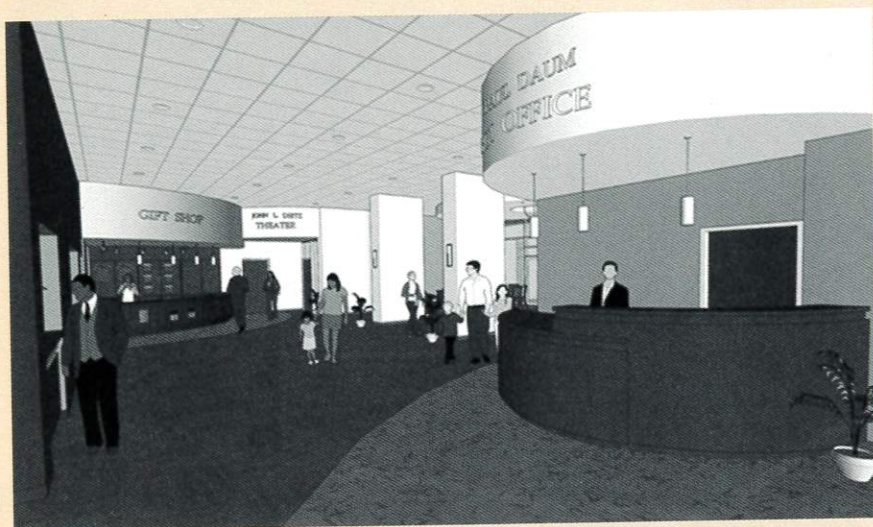

New Seats ♦ New Bathrooms ♦ Expanded Lobby

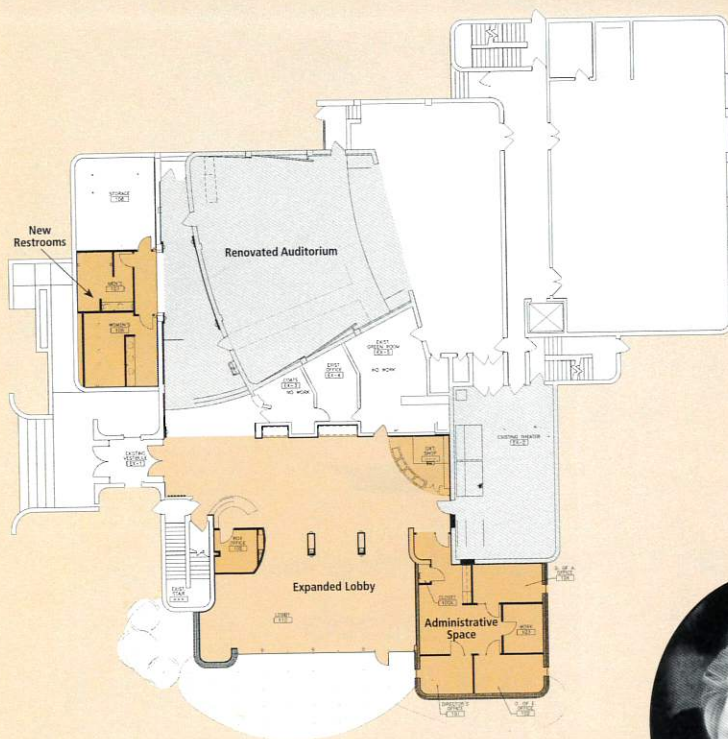

*"I urge you to support Weathervane Playhouse's Capital Campaign. Live theater is where I started and continue to work and is an essential element to a thriving and enlightened community."*

**Olympia Dukakis**  
Academy Award-winning Actress





Weathervane

—PLAYHOUSE—

John Hedges, Executive Director

*A World-Premiere  
Whodunit!*

# Bloody Murder.

Several colorful English murder mystery types assemble for the weekend in the very lavish country estate of the esteemed Lady Somerset. Suddenly a man is murdered, but her Ladyship will not allow her guests to call the police. She insists that they're all characters in a mystery story written by a perfectly dreadful author and she won't allow it to go on any longer! What ensues is an hilarious battle of wills between the writer and his creations with an ending guaranteed to surprise.

Comedy by Ed Sala  
Directed by Nancy Cates

January 15 - February 1, 2009





# Weatheravane

PLAYHOUSE

John Hedges, Executive Director

1301 Weatheravane Lane  
Akron, OH 44313-5186

*Life Is Believing*  
2008-2009 Season

— Next on Stage —

A Midsummer  
Night's Dream

Feb. 10 - 22

Intimate  
Apparel

Feb. 26 - Mar. 14

# Bloody Murder

Jan. 15 - Feb. 1, 2009

## CAST

Lady Somerset.....Linda Ryan  
Jane.....Karen Wood  
Emma.....Tess Burgler  
Countess.....Dede Klein  
Major.....Henry Bishop  
Trenaine.....Tom Stephan  
Charles.....Scott Shriner  
Phelps.....Ron Cuirle

Director.....Nancy Cates  
Stage Manager.....Jerry Mirman, Jr.  
Sound Designer.....Stephen Moushey  
Costume Designer.....Jasen J. Smith  
Lighting Designer.....Bob Schaefer  
Properties Designer.....Judy Willenssen  
Scenic Designer.....Alan Scott Ferrall  
Assistant Tech Dir.....Kathy Kohl

**TICKETS \$20**  
**ON SALE NOW!**  
Charge by Phone

Tue - Fri 10 a.m. - 5:30 p.m.  
Visa MasterCard Discover  
Buy Online  
weatheravaneplayhouse.com

S	M	T	W	T	F	S
<b>Jan. 15 - Feb. 1</b>	<b>15</b>	<b>16</b>	<b>17</b>			
	7:30 PM	8:00 PM	8:00 PM			
<b>18</b>				<b>22</b>	<b>23</b>	<b>24</b>
2:30 PM				7:30 PM	8:00 PM	8:00 PM
<b>25</b>				<b>29</b>	<b>30</b>	<b>31</b>
2:30 PM				7:30 PM	8:00 PM	8:00 PM
<b>1</b>						
2:30 PM						

Season Support Provided By

**WILLIAM SCHAEFER**  
THAT SUPPORTS PUBLIC  
PROGRAMS IN THE ARTS

**WKSU**

**104.9**  
WCLV-licensed FM

**GOOD YEAR**